

GENERAL REFERENCE NOTES

- 1) TOTAL LOT AREA = 271.52 ACRES
- 2) OPEN SPACE
 - 60% REQUIRED
162.91 Ac. REQUIRED (60% OF 271.52 Ac.)
163.17 Ac. PROVIDED
 - 40% OF OPEN SPACE TO BE BUILDABLE
65.16 Ac. REQUIRED (40% OF 162.91 Ac.)
86.1± Ac.± PROVIDED
 - 50% OF BUILDABLE OPEN SPACE TO BE CONTIGUOUS
32.08 Ac. (50% OF 65.16 Ac.)
33.60 Ac. PROVIDED

33.6 Ac. CONTIGUOUS BUILDABLE OPEN SPACE

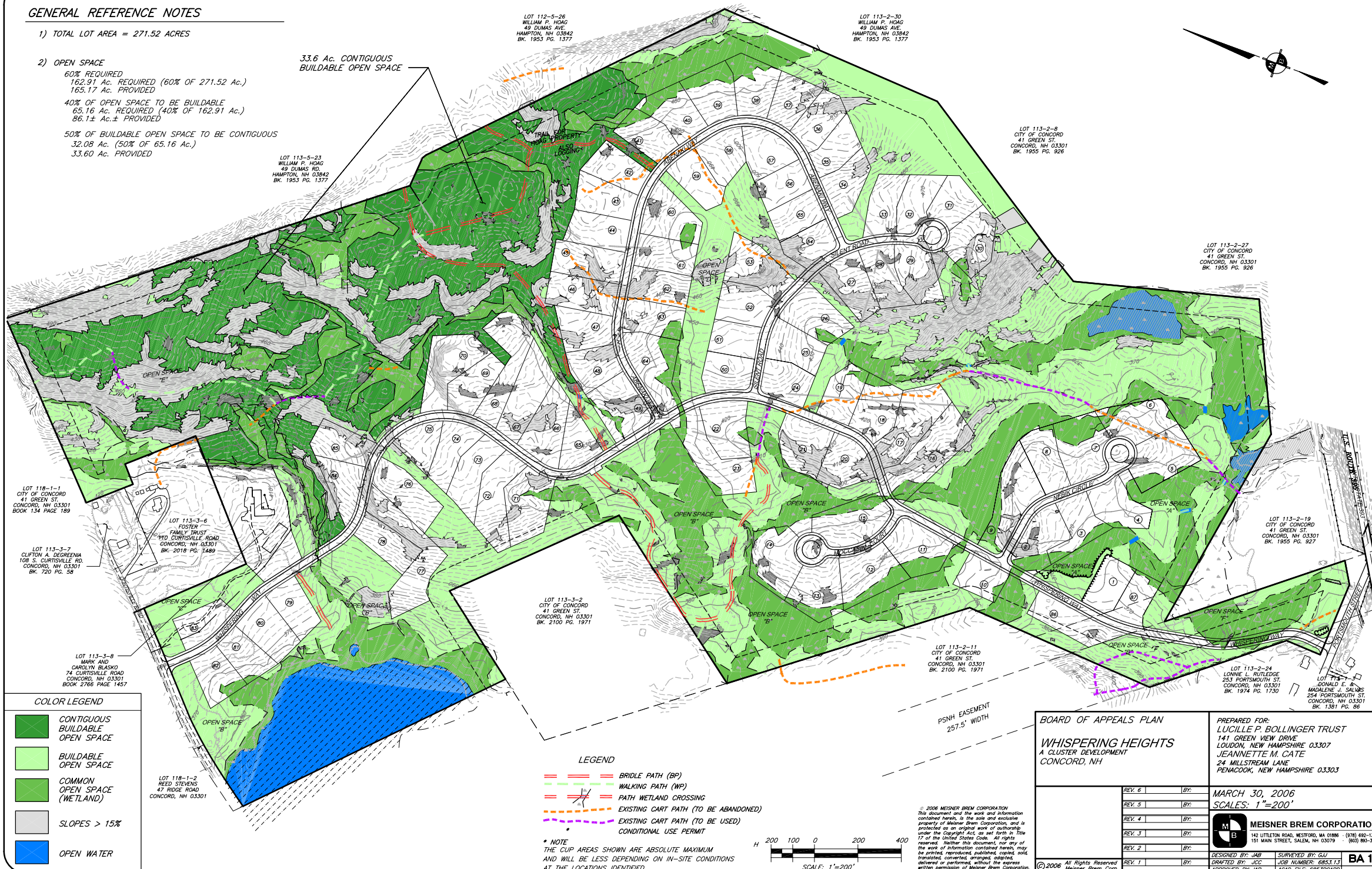

LOT 118-1-1
CITY OF CONCORD
41 GREEN ST.
CONCORD, NH 03301
BOOK 134 PAGE 189

LOT 113-3-7
CLIFTON A. DEGREENIA
108 S. CURTISVILLE RD.
CONCORD, NH 03301
BK. 720 PG. 58

LOT 113-3-6
FOSTER FAMILY TRUST
170 CURTISVILLE ROAD
CONCORD, NH 03301
BK. 2018 PG. 1489

LOT 113-3-8
MARK AND CAROLYN BLASKO
74 CURTISVILLE ROAD
CONCORD, NH 03301
BOOK 2766 PAGE 1457

LOT 118-1-2
REED STEVENS
47 RIDGE ROAD
CONCORD, NH 03301

LOT 113-5-23
WILLIAM P. HOAG
49 DUMAS RD.
HAMPTON, NH 03842
BK. 1953 PG. 1377

LOT 112-5-26
WILLIAM P. HOAG
49 DUMAS AVE.
HAMPTON, NH 03842
BK. 1953 PG. 1377

LOT 113-2-30
WILLIAM P. HOAG
49 DUMAS AVE.
HAMPTON, NH 03842
BK. 1953 PG. 1377

LOT 113-2-8
CITY OF CONCORD
41 GREEN ST.
CONCORD, NH 03301
BK. 1955 PG. 926

LOT 113-2-27
CITY OF CONCORD
41 GREEN ST.
CONCORD, NH 03301
BK. 1955 PG. 926

LOT 113-2-19
CITY OF CONCORD
41 GREEN ST.
CONCORD, NH 03301
BK. 1955 PG. 927

LOT 113-2-24
LOWNIE L. RUTLEDGE
253 FORTSMOUTH ST.
CONCORD, NH 03301
BK. 1974 PG. 1730

LOT 113-1-5
DONALD E. & MAURINE J. SALVES
254 FORTSMOUTH ST.
CONCORD, NH 03301
BK. 138 PG. 86

COLOR LEGEND

	CONTIGUOUS BUILDABLE OPEN SPACE
	BUILDABLE OPEN SPACE
	COMMON OPEN SPACE (WETLAND)
	SLOPES > 15%
	OPEN WATER

LEGEND

	BRIDLE PATH (BP)
	WALKING PATH (WP)
	PATH WETLAND CROSSING
	EXISTING CART PATH (TO BE ABANDONED)
	EXISTING CART PATH (TO BE USED)
	CONDITIONAL USE PERMIT

* NOTE THE CUP AREAS SHOWN ARE ABSOLUTE MAXIMUM AND WILL BE LESS DEPENDING ON IN-SITE CONDITIONS AT THE LOCATIONS IDENTIFIED.

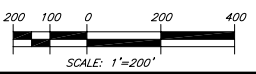

BOARD OF APPEALS PLAN		PREPARED FOR: LUCILLE P. BOLLINGER TRUST 141 GREEN VIEW DRIVE LOUDON, NEW HAMPSHIRE 03307 JEANNETTE M. CATE 24 MILLSTREAM LANE PENACOOK, NEW HAMPSHIRE 03303	
WHISPERING HEIGHTS A CLUSTER DEVELOPMENT CONCORD, NH		MARCH 30, 2006 SCALES: 1"=200'	
REV. 6	BY:	 MEISNER BREM CORPORATION 142 LITTLETON ROAD, WESTFOOT, MA 01886 (978) 692-1313 151 MAIN STREET, SALEM, NH 03079 (603) 883-3000 DESIGNED BY: JAB SURVEYED BY: GJM DRAFTED BY: JCC JOB NUMBER: 0853.113 APPROVED BY: JAB ACAD. FILE: 0653020402	
REV. 5	BY:		
REV. 4	BY:		
REV. 3	BY:		
REV. 2	BY:		
REV. 1	BY:		
©2006 All Rights Reserved Meisner Brem Corp.		BA 1	

© 2006 MEISNER BREM CORPORATION This document and the work and information contained herein, is the sole and exclusive property of Meisner Brem Corporation and is protected as an original work of authorship under the Copyright Act, as set forth in Title 17 of the United States Code. All rights reserved. Neither this document, nor any of the work of information contained herein, may be printed, reproduced, published, copied, sold, transferred, conveyed, arranged, adapted, delivered or performed, without the express written permission of Meisner Brem Corporation.